

MDTR



ARCHITECTURE



INSPIRED BY NATURE

After a decade of practicing architecture in the Balkans and China we decided to establish a new office in Montenegro.

We would love to show you some of our dearest designs so you can get to know us more.

Ana & Boris

About

www.meditera.me

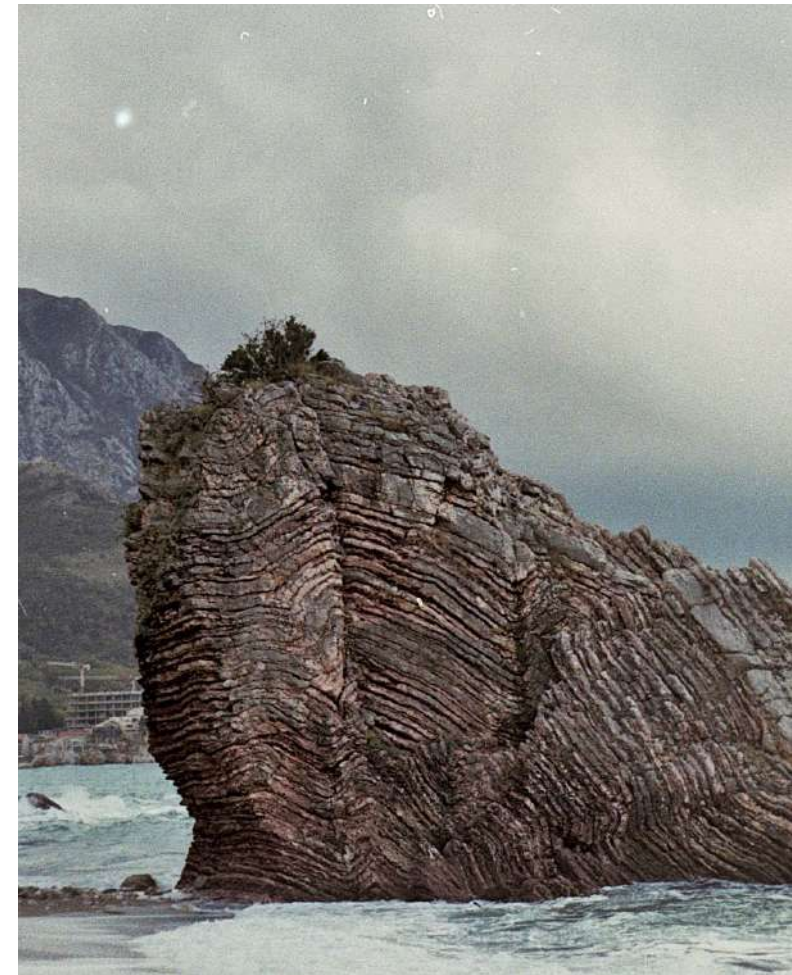

**MDTR is an universal
architecture and
urbanism practice
working with a natural
order and balance.**

We want to change the paradigm and upgrade typologies, redefine materials and combine tradition with technology, to find the best solution for a new century.

Virpazar Family House

REVITALIZATION DESIGN

LOCATION: VIRPAZAR, MONTENEGRO

YEAR: 2022

RECONSTRUCTION OF AN OLD STONE HOUSE

Old stone house located in a village near Virpazar revitalized in active collaboration with the client. Reconstruction has a new floor





Darkforest

COMPETITION PROPOSAL

YEAR: 2021

2ND PLACE AWARD

INT. COMPETITION - MINI HOME 2021

Darkforest house is located on the slopes of the Stara Planina Mountain and is designed to be a space for relaxation and work in a shadowy, forest environment. The starting idea was the notion of relativizing the boundaries between outdoor and indoor spaces. Large glass surfaces and skylights, a light wooden floor that extends from the interior to the edge of the porch, a dining table that continues outside, are all elements that connect the two spaces creating the feeling of unity.





Ruralna

PREFABRICATED MICRO HOUSE

LOCATION: CZECH REPUBLIC

YEAR: 2021

OFF-GRID MICRO HOUSE

The goal was to design a completely prefabricated and transportable small house, with a maximum area of 25m², which would provide the user with the most comfortable conditions for a longer stay.

The house is designed to give users a feeling of warmth and connection with the natural environment. Large glazed surfaces provide wide views and the penetration of natural light. When not in use, windows can be covered with panels.





Ashwood

PREFABRICATED MICRO HOUSE

LOCATION: CZECH REPUBLIC

YEAR: 2022

WEEKEND NATURE LOVERS MICRO HOUSE

Ashwood House is a luxury micro holiday home designed for the natural environment. This house of simple volumes treated with contrasting wood paneling can easily become a part of various natural, rural or suburban environments, and at the same time stand out with its pure form. The facility is designed so that it can be installed in the factory and transported from several parts to the desired destination. This house can be connected to the existing infrastructure network, or completely independent, with the addition of energy production and water supply systems, and their accompanying equipment. With an area of 25m², Ashwood House provides all the amenities for rest and work in nature.





Urbana

CONCEPTUAL DESIGN

YEAR: 2021

CARBON POSITIVE MICRO HOUSE

Faced with the problem of high pollution in cities, and aware of the need to participate in the modern dynamics of urban life, the design of this house is a reflection of the possibilities of ecological lifestyle and construction in today's cities. The compact shape of the house and its dimensions enable the positioning of the building on the roofs of the existing multi-story buildings, relying partly on the existing resources, but maintaining a high degree of energy autonomy.

The urban house is a complex 'organism' of combined systems with unusual technologies, which with a minimal and thoughtful design creates an atmosphere of home warmth in a very small space and challenging conditions.





**We are excited to
work with you.**

MDTR ARCHITECTURE

+38268063788

+381637058996

office@meditera.me

www.meditera.me

Vasa Raickovica 2b

81000 Podgorica

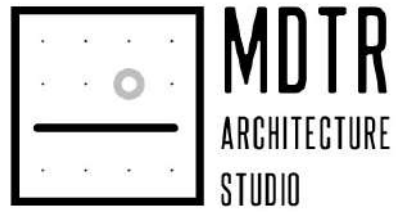

LOCATION SOCIAL MEDIA

Vasa Raičkovića 2b
81000
Podgorica
Montenegro (MNE)

 mdtr.studio

 mdtr.studio

office@meditera.me

+382 68 063 788

+381 63 705 8996

Studio

